

## LIFEJACKETS

- Lifejackets must be worn at all times on craft 6m or less when not tied up or at anchor
- Lifejackets of the right size to fit everyone on board must be carried on all craft

## SPEED OF VESSELS

- Keep to **5** knots or less within:
  - 200m of the shore
  - 200m of a vessel flying a dive flag 
  - 50m of a person in or on the water
  - 50m of another vessel
- If you are making a wash, you will most likely be exceeding **5** knots
- You must be at least 15 years old to operate a power boat
- It takes three to water-ski – have a lookout on board

## TIPS

- Keep a proper lookout for others in and on the water
- Keep well clear of other water users
- Watch the weather
- Make sure your vessel is well maintained
- Make sure you have enough fuel
- Don't mix drinking and boating
- Be aware of hazards

## THINK AHEAD

You should know what to do in the event of:

- Engine failure
- Fire
- Someone falls overboard
- Sinking

Your crew should be briefed on:

- Where safety equipment is located and how to use it
- What to do if the skipper is incapacitated

## STOP THE SPREAD

Protect our waters from aquatic pests. Remove water weed and algae from boats, and thoroughly check, clean and dry all equipment that has been in the water when leaving inland waterways.

## THE MORE YOU KNOW THE BETTER YOUR BOATING



Call on 0800 408 090  
or visit [www.cbcs.org.nz](http://www.cbcs.org.nz)

## BASIC RULES TO AVOID COLLISION

(for craft including jet skis)

### Vessel overtaking another

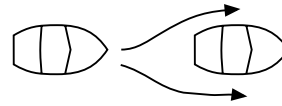

Every overtaking vessel gives way  
(this includes a sailing vessel)

### Power vessel meeting a sailing vessel

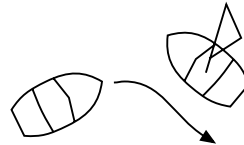

Power vessel gives way to sailing vessels

### Power vessels meeting head on

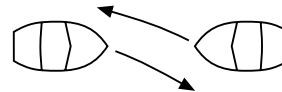

Each vessel alters course to starboard  
(right hand side)

### Power vessels meeting

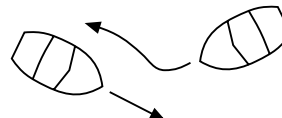

Give way to another vessel crossing from starboard  
(right hand side) i.e. give way to the right

# LAKE RUATANIWHA

## Navigation Safety Bylaws 2010



Everything is connected

Phone 0800 EC INFO (0800 324 636)  
24 Hour Pollution Hotline phone 0800 76 55 88  
For a copy of the bylaws, go to [www.ecan.govt.nz/navsafety](http://www.ecan.govt.nz/navsafety)

 **Environment  
Canterbury  
Regional Council**  
Kaunihera Taiao ki Waitaha

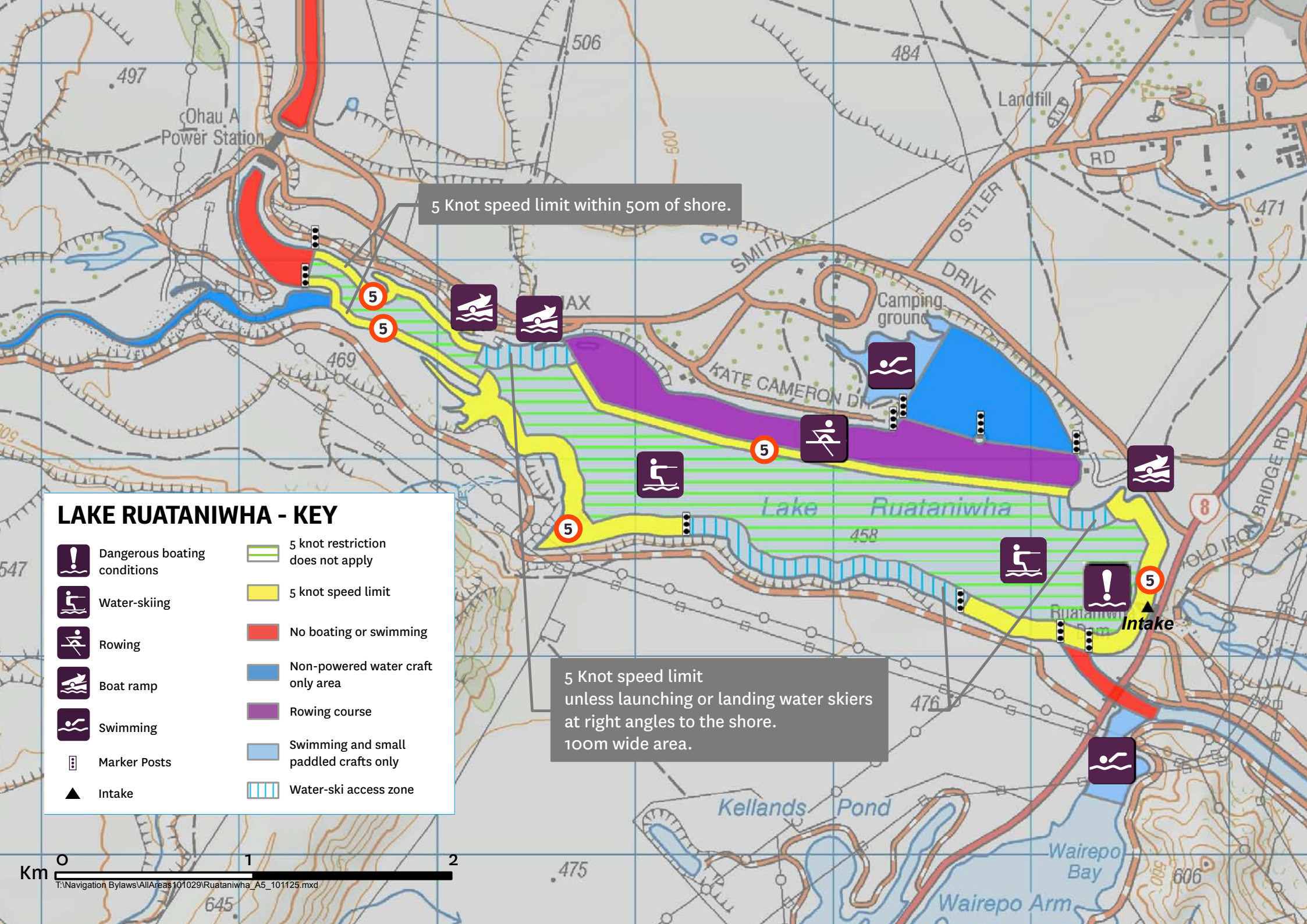

5 Knot speed limit within 50m of shore.

5 Knot speed limit unless launching or landing water skiers at right angles to the shore. 100m wide area.

### LAKE RUATANIWHA - KEY

	Dangerous boating conditions		5 knot restriction does not apply
	Water-skiing		5 knot speed limit
	Rowing		No boating or swimming
	Boat ramp		Non-powered water craft only area
	Swimming		Rowing course
	Marker Posts		Swimming and small paddled crafts only
	Intake		Water-ski access zone

